



LR7424X / LR7428X

DAY & NIGHT 1080P HD VARI-FOCAL IR IP CAMERA



LR7424X/LR7428X in the L series is featuring built-in Sense up+ technology to deliver stunning video in low-light conditions. Utilizing intelligent image signal processing, 2D WDR function, AGC control, and 3D Noise Reduction, the combination successfully delivers the ultimate low-light image without motion blur. The IP66-rated housing is designed to help the camera body withstand rain and dust and ensures operation under a multitude of harsh weather conditions. Support with PoE, privacy mask, White balance, and minimum illumination 0.25 Lux at F1.4 Low Light Mode.

FEATURES :

- Full HD 2 megapixel CMOS image sensor
- True H.264 AVC/MPEG-4 part 10
- H.264 and Motion JPEG triple Video streaming
- 3D Noise Reduction (MCTF)
- 2D WDR function
- Digital zoom supported
- Audio / Motion / alarm detection
- Cable managed housing and bracket
- High efficiency IR LED, Radiant distance up to 45m
- Day & Night (IR cut removable)
- 2-way audio supported
- Digital I/O : 1 in, 1 out
- ONVIF supported

DIMENSIONS : (Unit : mm)

Body : 121.5(W) x 109(H) x 231(D) Bracket : 160(L)

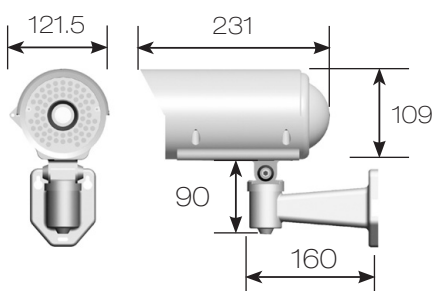

INSTALLATION HOLE SITE DIAGRAM :

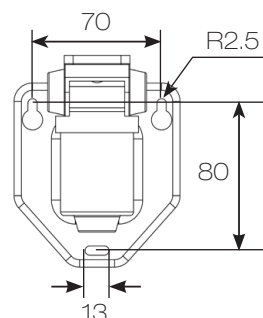

SPECIFICATION :

| | | | |
|-------------------------|------------------|--|---------------------|
| Name | | Day & Night 1080P HD vari-focal IR IP Camera | |
| Model | | LR7424EX3.6 | LR7428EX3.6 |
| Lens | Focal length | | 3.3 - 12 mm |
| | Iris | | F1.4 |
| | Angle of view | H | 79.3° - 29.8° |
| | | V | 59.4° - 22.4° |
| | | D | 99° - 37.3° |
| Pick up element | | 1/2.7" CMOS image sensor | |
| Effective pixels | | 1920 (H) x 1080 (V) = 2,073,600 (pixel) | |
| Chip size | | 5.856mm (H) x 3.276mm (V) | |
| Scanning system | | Progressive Scan | |
| Infrared cut filter | | Auto / Schedule / Day (Color) / Night (Mono) | |
| Min. illumination | | 0.1 Lux at F1.4 (Low Light Mode) / 0 Lux with IR LED ON | |
| White balance | | Auto / Tungsten / Indoor / Fluorescents1 / Fluorescents2 / Outdoor1 / Outdoor2 | |
| Back light compensation | | Off / On | |
| Electronic shutter | | 1/30(1/25)s - 1/8000s | |
| Sense up | | Off / 1 Frame / 2 Frames / 3 Frames / 7 Frames | |
| Sense up + | | Yes | |
| Auto gain control | | 36 dB Variable Gain | |
| 3D Noise Reduction | | Off / 1 - 32 Selectable | |
| 2D WDR | | Off / x2 / x3 / x4 | |
| Privacy masking | | Off / On (4 zones) | |
| Image effects | | Brightness, Contrast, Hue, Saturation, Sharpness, Mirror, Flip | |
| Live Video output | | CVBS 1.0Vp-p, 75 ohm, BNC connector | |
| Audio in / output | | Mono, 1.4 Vp-p , 50 KΩ , Terminal connector | |
| IP rating | | IP66 | |
| Window | | Ø92 Heat Resistant Glass | |
| Infrared LED | Peak wavelength | | 850nm |
| | Beam spread | | 30° |
| | Radiant distance | | 45M |
| Operating temperature | | -40°C - +50°C (-40°F - 122°F) | |
| Dimension | | Body : 121.5mm(W) x 109mm(H) x 231mm(D) , Bracket : 160mm(L) | |
| Weight | | 1700g | |
| Power supply | | AC24V (±10%) | AC100 - 240V (±10%) |
| | | PoE+ (IEEE 802.3at compliant) | |
| Power consumption | | 14W (PoE+, 16W) | |

| | |
|---------------------------|---|
| Network | |
| Video compression | H.264 , Motion JPEG |
| Resolution | 1080P(1920 x 1080), 720P(1280 x 720), D1(720 x 480), CIF(352 x 240) |
| Maximum frame rate | H.264 : up to 15 fps @ 1920 x 1080 , 30fps @ 1280 x 720 , 30fps @ 720 x 480 Motion JPEG : up to 15 fps @ 1920 x 1080 , 30 fps @ 720 x 480 , 30 fps @ 352 x 240 |
| Video streaming protocol | RTP/HTTP, RTP/TCP, RTP/UDP, Multicast |
| Video bitrate | 128Kbps - 5Mbps Frame rate and bit rate controllable on-the-fly VBR / CBR / GOP supported |
| Security | Base64 HTTP encryption Multiple user access levels with password protection 10 user accounts available |
| Users | 8 simultaneous users |
| Digital zoom | Yes |
| OSD | Text overlay for date, time, and camera name |
| Alarm function | Alarm / motion detection triggering recording into SD card Image upload over FTP and E-mail by audio / motion detection |
| CPU, memory | Embedded SoC ARM11, 528MHz, 256MB DDR2, 256MB flash memory |
| Maintenance | Firmware update via HTTP Firmware available at web site |
| Network interface | 10Mbps / 100Mbps Base-T, RJ-45 |
| PC requirement | OS : Windows 2000, Windows XP, Windows Vista, Windows 7, Windows 8 Browser : Windows Internet Explorer 6.0 or above CPU : Intel Pentium 4 1.8GHz or above RAM : 1GB or above, Independent Display Card |
| Network protocols | IP, TCP, UDP, HTTP, SMTP, NTP, DDNS, UPnP, FTP, ARP, DHCP, PPPoE, DNS, RTSP, RTCP, Telnet, ICMP, IGMP, ONVIF Profile S, SNMP, SIP, Bonjour |
| Mobile phone | iPhone, iPad, and Android support |
| System integration | ONVIF & LILIN HTTP API |
| Central management system | CMX 3.6 / NAV 1.0 support |
| Video display | LILIN Universal ActiveX & LILIN Java Applet |
| OS | Embedded Linux 2.6.32 |
| Two-way audio | G.711 / PCM |
| SD card recording | Support Micro SD/SDHC card for circular recording (card is not included) |
| Alarm input / output | Digital 1 input (TTL, +3 - 5VDC) / 1 Output (MOS Relay contact N.O., Load max. 40VDC/300mA) |

