

# DynaHawk™ WA Series

Full HD Multiple Streams Compact Dome IP Camera



The Full HD Multiple Streams Compact Dome IP Camera is a compact camera with an easy setup design. High Power PoE is supported to reduce complicated cabling without sacrificing performance. Quad Streams Compression (H.264 Baseline / Main / High Profile + MJPEG) are supported for efficient bandwidth and storage management. For dark environments, the camera has incorporated WDR, 3DNR and Day/Night ICR technologies to capture clear images in lowlight conditions.

In addition, full ONVIF compatibility creates powerful connection between WA series with any VMS. With comprehensive mounting accessories, camera can be easily installed for different application.

## ■ Key Features

- Progressive Scan CMOS Sensor
- Dual Streaming- Full HD 1080P Real Time + D1 Real Time
- Quad Streams Compression- H.264 Baseline / Main / High Profile + MJPEG
- Multi-language Support
- Tampering Alarm
- Remote Zoom & Focus (Motorized Lens)\*
- Wide Dynamic Range
- Motion Detection
- Privacy Masks
- Smart Picture Quality / 3D Noise Reduction
- Vertical View Mode (Image rotation by 90 degrees)
- Smart IR Mode
- Network Failure Detection
- Day/Night (ICR)
- IR LED Module (working distance up to 25 m)\*
- microSD Support
- BNC analog output
- Weatherproof (IP66 International)
- High Power PoE (PoE+)
- ONVIF Support

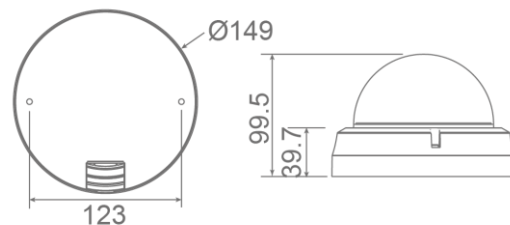

# DynaHawk™ WA Series - Compact Dome IP Camera

| Camera                   |                  | W3A2-A   | W3S1-A  |
|--------------------------|------------------|--|---|
| Image Sensor             |                  | 1/2.5" Progressive CMOS  | 1/2.8" Sony Progressive CMOS  |
| Effective Pixels         |                  | 2592(H) x 1944(V)  | 2048(H) x 1536(V)   |
| Minimum Illumination     |                  | Motorized & Vari-focal: TBD<br>3x AF: 0.2 lux (Color)/ 0.02 lux (B/W)  | Motorized & Vari-focal: 0.2 lux (Color)/ 0.02 lux (B/W)<br>3x AF: 0.2 lux (Color)/ 0.02 lux (B/W) |
| Shutter Speed            |                  | 1 ~ 1/10000 sec.   |   |
| Lens                     |                  | Vari-focal / Motorized / Auto Focus  |   |
| Focal Length             |                  | Vari-focal / Motorized: 3.3 - 10.5 mm<br>3x AF: 3.6 - 9mm  | Motorized & Vari-focal : 3 - 10.5mm<br>3x AF: 3 - 9mm   |
| F Number                 |                  | Motorized & Vari-focal: F1.4<br>3x AF: F1.2  | Motorized & Vari-focal: F1.4<br>3x AF: F1.2   |
| FOV                      |                  | Motorized & Vari-focal: 87.88° (Wide); 34.35° (Tele)<br>3x AF: 104° (wide); 37° (Tele)   | Motorized & Vari-focal: 95° (Wide) ; TBD (Tele)<br>3x AF: 99.78° (Wide) ; 35.18° (Tele)           |
| Operation                |                  | English / French / German / Italian / Japanese / Korean / Portuguese / Russian / Simplified Chinese / Spanish / Traditional Chinese  |   |
| Multiple Languages       |                  | English / French / German / Italian / Japanese / Korean / Portuguese / Russian / Simplified Chinese / Spanish / Traditional Chinese  |   |
| IRIS Control*            |                  | 3x: P-IRIS & DC-IRIS<br>Motorized & Vari-focal: DC-IRIS  |   |
| Backlight Compensation   |                  | On / Off   |   |
| White Balance            |                  | Manual / AWB / ATW / One Push  |   |
| 3D Noise Reduction       |                  | On / Off   |   |
| Wide Dynamic Range       |                  | On / Off   |   |
| Privacy Mask             |                  | On / Off   |   |
| Brightness               |                  | Manual   |   |
| Exposure                 |                  | Auto / Manual  |   |
| Sharpness                |                  | Manual   |   |
| Contrast                 |                  | Manual   |   |
| Saturation               |                  | Manual   |   |
| Hue                      |                  | Manual   |   |
| Digital Zoom             |                  | Support  |   |
| Motion Detection         |                  | On / Off / By Schedule   |   |
| Privacy Mask Type        |                  | Color  |   |
| ICR                      |                  | Auto / On / Off / Smart  |   |
| ICR+IR LED*              |                  | Auto / LED On / LED Off / Smart IR / Light Sensor  |   |
| Tampering Alarm          |                  | On / Off / By Schedule   |   |
| Two-way Audio            |                  | Line in / Line Out   |   |
| Audio Compression        |                  | G.711/G.726  |   |
| Network                  |                  | RJ-45, 10/100 Mbps Ethernet  |   |
| Interface                |                  | H.264 (MPEG-4 Part 10/AVC) / MJPEG   |   |
| Video Compression        |                  | Dual Streams H.264 + MJPEG / H.264 + H.264<br>Quad Streams H.264*3 + MJPEG / H.264*4   |   |
| Video Streaming          |                  | H.264- 2592 x 1944 (5M) / 2048 x 1536 (3M) / Full HD 1080P / SXGA / HD 720P / XGA / SVGA / D1 / VGA / CIF<br>MJPEG- Full HD 1080P / SXGA / HD 720P / XGA / SVGA / D1 / VGA / CIF   |   |
| Video Resolution         |                  | H.264- 2048 x 1536 (3M) / Full HD 1080P / SXGA / HD 720P / XGA / SVGA / D1 / VGA / CIF<br>MJPEG- Full HD 1080P / SXGA / HD 720P / XGA / SVGA / D1 / VGA / CIF  |   |
| Frame Rate               |                  | 5M Dual Streams - H.264 2592 x 1944 (12 fps) + H.264/MJPEG D1 (12 fps)<br>3M Dual Streams - H.264 2048 x 1536 (15 fps) + H.264/MJPEG 720p (15 fps)<br>2M Dual Streams - H.264 1080P (30/25 fps) + H.264/MJPEG D1 (30/25 fps) |   |
| Protocol                 |                  | 3M Dual Streams - H.264 2048 x 1536 (15 fps) + H.264/MJPEG 720p (15 fps)<br>2M Dual Streams - H.264 1080P (30/25 fps) + H.264/MJPEG D1 (30/25 fps)   |   |
| Security                 |                  | ARP, IPv4/v6, TCP/IP, UDP, RTP, RTSP, HTTP, HTTPS, ICMP, FTP, SMTP, DHCP, PPPoE, UPnP, IGMP, SNMP, QoS, ONVIF  |   |
| Alarm                    | Input            | 1 Set<br>5V 10kΩ pull up   |   |
|                          | Output           | 1 Set<br>Photo Relay Output 300V DC/AC   |   |
| Event Notification       |                  | HTTP / FTP / SMTP  |   |
| Micro SD                 |                  | microSDHC 32GB support   |   |
| Supported Web Browser    |                  | Internet Explorer (6.0+) / Chrome / Firefox / Safari   |   |
| User Account             |                  | 20   |   |
| Password Levels          |                  | User and Administrator   |   |
| Mechanical               |                  | up to 25 m   |   |
| Built-in IR Illuminator* | Working Distance | 850 nm   |   |
|                          | Wavelength       | 24   |   |
|                          | Number of LEDs   | Power / Link / ACT   |   |
| LED Indicator            |                  | 4 of 9 Pin Terminal Block  |   |
|                          | Alarm            | 4 Pin Terminal Block   |   |
|                          | Power            | RJ-45  |   |
| Connectors               | Ethernet         | 1.0 Vp-p / 75 Ω, BNC   |   |
|                          | Analog Video     | 5 of 9 Pin Terminal Block  |   |
|                          | Audio*           |  |   |
| General                  |                  | -10°C ~ 50°C (14° ~ 122° F)<br>w/Heater, powered by DC12V/AC24V/PoE+ : -40°C ~ 50°C (-40° ~ 122° F)  |   |
| Operating Temperature    |                  | 10% ~ 90%, No Condensation   |   |
| Humidity                 |                  | IP66   |   |
| Weatherproof Standard*   |                  | Ø 133 x 115 mm (Ø 5.2 x 4.5 in. )  |   |
| Dimension                |                  |  |   |
| Weight                   |                  | w/ Heater, DC 12V / AC 24V / PoE+  |   |
| Power Source             |                  | System : max 5W  |   |
| Power Consumption        |                  | (IRLED : +max 3.6W / Heater : +max 6.5W / Motorized : +max 2.5W / 3x AF : +max 2.5W)   |   |
| Regulatory               |                  | CE / FCC   |   |

\* mark for optional items

Product specification and availability are subject to change without notice.



DYNACOLOR, INC.

No. 116, Jou Tz Street, Neihu, Taipei 114, Taiwan

TEL: (886)2-2659-8898

FAX: (886)2-2659-8868

http://www.dynacolor.com.tw

info@dynacolor.com.tw