

DynaHawk™ XA Series

Full HD Multiple Streams Ultra-WDR Compact Dome IP Camera



The Full HD Multiple Streams Ultra-WDR Compact Dome IP Camera is a compact camera with an easy setup design. High Power PoE is supported to reduce complicated cabling without sacrificing performance. Quad Streams Compression (H.264 Baseline / Main / High Profile + MJPEG) are supported for efficient bandwidth and storage management. The H.264 encoder performance is up to 1080P 60fps. Also, the product series can supply dual Full HD 1080P real-time streaming.

With more computing power, the IP Camera could provide more flexibility for users and system managers. The IP camera also supports Shutter WDR function, which can provide better image quality under extreme light contrast scenario or light changing environments.

■ Key Features

- Sony Progressive Scan CMOS Sensor
- 1.3M / 2M Resolution*
- Quad Streams Support
- Dual Streams, Full HD 1080P Real Time + Full HD 1080P Real Time
- Quad Streams Compression: H.264 Baseline / Main / High Profile + MJPEG
- Multi-language Support
- Tampering Alarm
- Ultra Dynamic Range
- Motion Detection
- Privacy Masks
- 3D Noise Reduction / 2D Noise Reduction
- Network Failure Detection
- Day/Night (ICR)
- IR LED Module (working distance up to 25m)*
- Digital Image Stabilization (DIS)
- BNC Analog Output
- Weatherproof (IP66 International)*
- High Power PoE (PoE+)
- Micro SD Support
- ONVIF Support

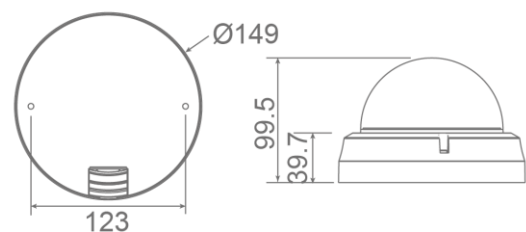

DynaHawk™ XA Series - Compact Dome IP Camera

Camera	X056-A	X057-A	X05B-A	
Image Sensor	1/3" Sony Progressive CMOS	1/2.8" Sony Progressive CMOS	1/1.9" Sony Progressive CMOS	
Effective Pixels	1280(H) x 1024(V)	1920(H) x 1080(V)	1920(H) x 1080(V)	
Minimum Illumination	3X AF: TBD Motorized Lens & Vari-focal: TBD	3X AF: 0.01 lux (Color)/ 0.001 lux (B/W) Motorized Lens & Vari-focal: TBD	TBD	
Shutter Speed		1 ~ 1/10000 sec.		
Lens				
Lens	Vari-focal / Motorized / 3x Optical Zoom, Auto Focus		Vari-focal / Motorized	
Focal Length	3x AF: 3 - 9mm Optical Zoom, Auto Focus Motorized Lens & Vari-focal: 3 - 10.5 mm		Motorized Lens & Vari-focal: 3.3 - 8 mm	
F Number	3x AF: F1.2 (Wide); F2.1 (Tele) Motorized Lens & Vari-focal: F1.4		Motorized Lens & Vari-focal: F1.5	
FOV	3X AF: 92.9° (Wide); 30.9° (Tele) Motorized Lens & Vari-focal: 75.6° (Wide); 28.7° (Tele)	3X AF: 135.6° (Wide); 45.5° (Tele) Motorized Lens & Vari-focal: 93.2° (Wide); 31.9° (Tele)	Motorized Lens & Vari-focal: 115° (Wide); 55.7° (Tele)	
Operation				
Multiple Languages	English / French / German / Italian / Japanese / Korean / Portuguese / Russian / Simplified Chinese / Spanish / Traditional Chinese			
Image Setting	IRIS Control*	DC Iris		
	Backlight Compensation	On / Off		
	White Balance	Manual / AWB / ATW / One Push		
	Noise Reduction 3D/2D	Low / Middle / High / Off		
	Wide Dynamic Range	Shutter WDR (120dB)	Shutter WDR (96dB)	Shutter WDR (96dB)
	Privacy Mask	On/Off		
	Brightness	Manual		
	Exposure	Auto / Manual		
	Sharpness	Manual		
	Contrast	Manual		
	Saturation	Manual		
	Hue	Manual		
	Digital Zoom	Support		
	Motion Detection	On / Off / By Schedule		
	Privacy Mask Type	Color		
	ICR	Auto / On / Off / Smart		
ICR + IR LED*	Auto / LED On / LED Off / Smart IR / Light Sensor			
Tampering Alarm	On / Off / By Schedule			
Digital Image Stabilization	On/Off			
Audio	Two-way Audio	Line in / Line Out		
	Compression	G.711/G.726		
Network				
Interface	RJ-45, 10/100/1000 Mbps Ethernet (Giga Ethernet)			
Video Compression	H.264 (MPEG-4 Part 10/AVC) / MJPEG			
Video Streaming	Dual Streams	H.264 720P(50/60 fps) + H.264/MJPEG SVGA(50/60 fps)	PAL: H.264 1080P(50 fps) + H.264/MJPEG D1(50 fps) NTSC: H.264 1080P(60 fps) + H.264 D1 (30 fps) H.264 1080P(60 fps) + MJPEG VGA (30 fps)	
	Quad Streams	H.264 SXGA(25/30 fps) + H.264 720P(25/30 fps) + H.264 SVGA(25/30 fps) + H.264/MJPEG CIF(25/30 fps)	H.264 1080P(25/30 fps) + H.264 720P(25/30 fps) + H.264/MJPEG CIF(25/30 fps)	
Video Resolution	SXGA / HD 720P / XGA / SVGA / D1 / VGA / CIF / QCIF @50/60fps (2 shutter WDR) or 25/30fps (4 shutter WDR)	Full HD 1080P / SXGA / HD 720P / XGA / SVGA / D1 / VGA / CIF / QCIF @50/60fps or 25/30fps (2 shutter WDR)		
Protocol	IPv4/v6, TCP/IP, UDP, RTP, RTSP, HTTP, HTTPS, ICMP, FTP, SMTP, DHCP, PPPoE, UPnP, IGMP, SNMP, QoS, ONVIF			
Security	HTTPS / IP Filter / IEEE 802.1X			
Alarm	Input	1 Set 5V 10kΩ pull up		
	Output	1 Set Photo Relay Output 300V DC/AC		
	Event Notification	HTTP / FTP / SMTP		
Micro SD	microSDHC 32GB support			
Supported Web Browser	Internet Explorer (6.0+) / Chrome / Firefox / Safari			
User Account	20			
Password Levels	User and Administrator			
Mechanical				
Built-in IR Illuminator*	Working Distance	up to 25 m		
	Wavelength	850 nm		
	Number of LEDs	24		
LED Indicator	Power / Link / ACT			
Connectors	Alarm	4 of 9 Pin Terminal Block		
	Power	4 Pin Terminal Block		
	Ethernet	RJ-45		
	Analog Video	1.0 Vp-p / 75 Ω, BNC		
Audio*	5 of 9 Pin Terminal Block			
General				
Operating Temperature	-10°C ~ 50°C (14° ~ 122°F) w/Heater, powered by DC12V/AC24V/PoE+ : -40°C ~ 50°C (-40° ~ 122° F)			
Humidity	10% ~ 90%, No Condensation			
Weatherproof Standard*	IP66			
Dimension	Ø149 x 99.53 mm			
Weight	Vari-focal: 480 g (1.06 lb)			
	Motorized: 490 g (1.08 lb)			
	3X AF: 650 g (1.43 lb)			
Power Source	DC 12V / AC 24V / PoE+			
Power Consumption	System : max 5.6W IRLED : +max 3.6W / Heater : +max 7W / Motorized : +max 1.9W / 3x AF : +max 3.2W			
Regulatory	CE / FCC			

* mark for optional items

Product specification and availability are subject to change without notice.



DYNACOLOR, INC.

No. 116, Jou Tz Street, Neihu, Taipei 114, Taiwan

TEL: (886)2-2659-8898

FAX: (886)2-2659-8868 <http://www.dynacolor.com.tw>

info@dynacolor.com.tw