

DynaHawk™ XN Series

Full HD Multiple Streams Ultra-WDR Mini Dome Camera



The Full HD Multiple Streams Ultra-WDR Mini Dome IP Camera is an easy setup camera with PoE supported to reduce complicate cabling without sacrificing performance. Quad Streams Compression (H.264 Baseline / Main / High Profile + MJPEG) are supported for efficient bandwidth and storage management. The H.264 encoder performance is up to 1080P 60 fps. Also, the product series can supply Dual Full HD 1080P Real-time streaming. With more computing power, the IP camera could provide more flexibility for users and system managers. The camera also supports Shutter WDR function, which can provide high quality images under extreme light contrast or light changing scenarios.

■ Key Features

- Sony Progressive Scan CMOS Sensor
- 1.3M / 2M Resolution*
- Quad Streams Support
- Dual Streams- Full HD 1080P Real-time + Full HD 1080P Real-time
- Quad Stream Compression- H.264 Baseline / Main / High Profile + MJPEG
- Multi-language Support
- Tampering Alarm
- Ultra Dynamic Range
- Motion Detection
- Privacy Masks
- 3D / 2D Noise Reduction
- Network Failure Detection
- Day/Night (ICR)
- IR LED Module (working distance up to 25 m)*
- Digital Image Stabilizer (DIS)
- BNC Analog Output*
- Weatherproof (IP66 International)*
- microSD Support
- ONVIF Support

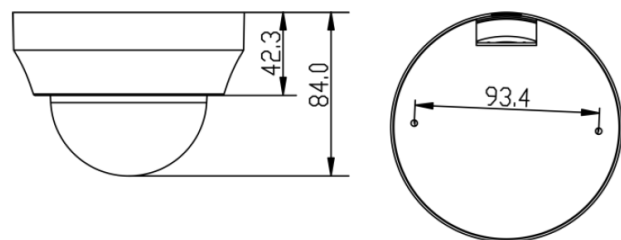

DynaHawk™ XN Series - Mini Dome IP Camera

Camera	X05B-N	X057-N	X056-N	
Image Sensor	1/1.9" Sony Progressive CMOS	1/2.8" Sony Progressive CMOS	1/3" Sony Progressive CMOS	
Effective Pixels	1920(H) x 1080(V)	1920(H) x 1080(V)	1280(H) x 1024(V)	
Minimum Illumination		TBD		
Shutter Speed		1 ~ 1/10000 sec.		
Lens				
Focal Length	4mm		Board Lens - 3.6 mm / 2.8 mm Vari-focal - 3-6mm	
F Number	F1.8		3.6 mm - F1.8 / 2.8 mm - F2.0 / VF 3-6mm - F2.0	
FOV	112.6° (H)	3.6 mm - 78° (H) 2.8 mm - 112.6° (H) VF 3-6mm - TBD	3.6 mm - 71.4° (H) 2.8 mm - 102° (H) VF 3-6mm - TBD	
Operation				
Multiple Languages	English / French / German / Italian / Korean / Simplified Chinese / Traditional Chinese / Russian / Portuguese / Spanish / Japanese			
Image Setting	Backlight Compensation	On / Off		
	White Balance	Auto / Manual / ATW / Indoor / Outdoor		
	Noise Reduction 3D/2D	Low / Middle / High / Off		
	Wide Dynamic Range	Shutter WDR (96dB)	Shutter WDR (120dB)	
	Privacy Mask	On / Off		
	Brightness	Manual		
	Exposure	Auto / Manual		
	Sharpness	Manual		
	Contrast	Manual		
	Saturation	Manual		
	Hue	Manual		
	Digital Zoom	Support		
	Motion Detection	On / Off / By Schedule		
	Privacy Mask Type	Color		
	ICR	Auto / On / Off / Smart		
	ICR + IR LED*	Auto / LED On / LED Off / Smart IR / Light Sensor		
	Tampering Alarm	On / Off / By Schedule		
Digital Image Stabilization (DIS)	On/Off			
Audio	Two-way Audio	Line in / Line out		
	Compression	G.711/G.726		
Network				
Interface	RJ-45, 10/100/1000 Mbps Ethernet (Giga Ethernet)			
Video Compression	H.264 (MPEG-4 Part 10/AVC) / MJPEG			
Video Streaming	Dual Streams	PAL: H.264 1080P(50 fps) + H.264/MJPEG D1(50 fps) NTSC: H.264 1080P(60 fps) + H.264/MJPEG D1(30 fps)	H.264 720P(50/60 fps) + H.264/MJPEG 720P(50/60 fps)	
	Quad Streams	H.264 1080P(25/30 fps) + H.264 720P(25/30 fps) + H.264 720P(25/30 fps) + H.264/MJPEG CIF(25/30 fps)	H.264 SVGA(25/30 fps) + H.264 720P(25/30 fps) + H.264 SVGA(25/30 fps) + H.264/MJPEG CIF(25/30 fps)	
Video Resolution	Full HD 1080P / SXGA / HD 720P / XGA / SVGA / D1 / VGA / CIF / QCIF @50/60fps or 25/30fps (2 shutter WDR)			
Protocol	ARP, IPv4/v6, TCP/IP, UDP, RTP, RTSP, HTTP, HTTPS, ICMP, FTP, SMTP, DHCP, PPPoE, UPnP, IGMP, SNMP, QoS, ONVIF			
Security/Authorization	HTTPS / IP Filter / IEEE 802.1X			
Alarm	Input	1 Set		
	Output	5V 10kΩ pull up 1 Set Photo Relay Output 300V DC/AC		
Event Notification	HTTP / FTP / SMTP			
Micro SD*	microSDHC 32GB support			
Supported Web Browser	Internet Explorer (6.0+) / Chrome / Firefox / Safari			
User Account	20			
Password Levels	User and Administrator			
Mechanical				
Built-in IR Illuminator*	Working Distance	Up to 25m		
	Wavelength	850 nm		
	Number of LEDs	21		
LED indicator	Power / Link / ACT			
Connectors	Type	Indoor	Outdoor	
	Alarm	4 of 8 Pin Terminal Block (Female)	4 Pin Terminal Block (Male)	
	Power	3 Pin Terminal Block (Female)	3 Pin Terminal Block (Male)	
	Ethernet	RJ-45		
	Analog Video	1.0 Vp-p / 75 Ω / BNC cable* (Installation purpose)	1.0 Vp-p / 75 Ω / BNC cable	
	Audio	4 of 8 Pin Terminal Block (Female)	Stereo phone jack, Ø 3.5 mm	
General				
Operating Temperature	-10°C ~ 50°C (14° ~ 122° F)			
Humidity	10% ~ 90%, No Condensation			
Weatherproof Standard*	IP66			
Dimension	Ø 117 x 84 mm (Ø 4.6 x 3.6 in.)			
Weight	220 g			
Power Source	PoE / DC 12V / AC 24V			
Power Consumption	System: 7W (Built-in IR Illuminator: +1W)			
Regulatory	FCC / EMC / LVD / RoHS			

* mark for optional items

Product specification and availability are subject to change without notice.