

DynaHawk™ ZN Series

Ultra High Definition Mini Dome Camera



The Ultra High Definition Multiple Streams Mini Dome IP Camera is an easy setup camera with PoE supported to reduce complicate cabling without sacrificing performance. Quad Streams Compression (H.264 Baseline / Main / High Profile / SVC + MJPEG) are supported for efficient bandwidth and storage management. Up to 4M real time resolution is offered for providing high definition images. Also, the H.264 encoder performance can up to 1080p 60 fps. For dark environments, the camera has incorporated WDR, 3DNR and Day/Night ICR technologies to capture clear images in lowlight conditions.

■ Key

- Sony Progressive Scan CMOS Sensor 4M / 3M Resolution
- Multi-exposure HDR (Multi-exposure Sensors is required)*
- Low Latency Streaming
- Low Power Consumption on Encoding
- Quad codec support (H.264 Baseline / Main Profile / High Profile / SVC + MJPEG)
- Quad Streams Support
- Tampering Alarm
- Motion Detection
- Text Overlay and Privacy Masks
- 3D Motion Compensated Noise Reduction (MCTF)
- Network Failure Detection
- True Day/Night Function (ICR)
- IR LED Module support (working distance up to 30m) *
- Weatherproof (IP66 International)*
- 64GB micro SD Card support
- ONVIF Profile S Support

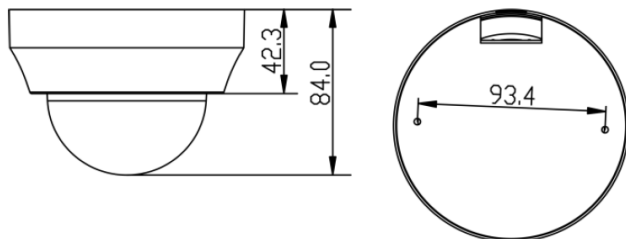

DynaHawk™ ZN Series - Mini Dome IP Camera

Camera		Z2SD-N	Z2V6-N	
Image Sensor		1/2.8" Sony Progressive CMOS	1/3" Progressive CMOS	
Effective Pixels		3M (2048x1536)	4M (2688x1520)	
Minimum Illumination	Color	TBD	TBD	
	B/W	TBD	TBD	
Shutter Speed		1 ~ 1/10000 sec.		
Lens				
Lens		Board Lens		
Focal Length		3.6 mm		
F Number		F 1.8		
FOV		TBD		
Operation				
Multiple Languages		English / French / German / Italian / Japanese / Korean / Portuguese / Russian / Simplified Chinese / Spanish / Traditional Chinese		
Image Setting	Iris Control*	DC Iris / P-iris		
	Backlight Compensation	On/Off		
	White Balance	Auto / Manual / ATW / Indoor / Outdoor		
	Noise	3D	Low / Middle / High / Off (w/ Motion Compensation)	
	Wide Dynamic Range	Shutter WDR On / Off		
	Privacy Mask	On/Off		
	Brightness	Manual		
	Exposure	Auto / Manual		
	Sharpness	Manual		
	Contrast	Manual		
	Saturation	Manual		
	Hue	Manual		
	Digital Zoom	Support		
	Motion Detection	On / Off / By Schedule		
	Privacy Mask Type	Color		
	ICR	Auto / On / Off / Smart		
	ICR + IR LED*	Auto / LED On / LED Off / Smart IR / Light Sensor		
Tampering Alarm	On / Off / By Schedule			
Audio	Two-way Audio	Line in / Line Out		
	Compression	G.711/G.726		
Network				
Interface		RJ-45, 1Gbps Ethernet		
Video Compression		MJPEG / H.264 (MPEG-4 Part 10/AVC) Baseline / Main Profile / High Profile / SVC		
Video Streaming	Dual Streams	H.264 3M @25/30 fps + H.264 SXGA @25/30 fps Note: 1 of the 2M or under streamings can be MJPEG	H.264 4M @25/30 fps + H.264 SVGA @25/30 fps Note: 1 of the 2M or under streamings can be MJPEG	
	Quad Streams	H.264 3M @25/30 fps + H.264 720P @25/30 fps + H.264 D1 @25/30 fps + H.264 CIF @25/30 fps Note: 1 of the 2M or under streamings can be MJPEG	H.264 4M @25/30 fps + H.264 VGA @25/30 fps + H.264 CIF @25/30 fps + H.264 CIF @25/30 fps Note: 1 of the 2M or under streamings can be MJPEG	
Video Resolution	H.264	3M (2048x1536) / Full HD 1080P / SXGA / 720P / XGA / SVGA / D1 / VGA / CIF / QVGA	4M (2688x1520) / Full HD 1080P / SXGA / 720P / XGA / SVGA / D1 / VGA / CIF / QVGA	
	MJPEG	Full HD 1080P / SXGA / 720P / XGA / SVGA / D1 / VGA / CIF / QVGA	Full HD 1080P / SXGA / 720P / XGA / SVGA / D1 / VGA / CIF	
Protocol		IPv4/v6, TCP/IP, UDP, RTP, RTSP, HTTP, HTTPS, ICMP, FTP, SMTP, DHCP, PPPoE, UPnP, IGMP, SNMP, QoS, ONVIF		
Security		HTTPS / IP Filter / IEEE 802.1X		
Alarm	Input	1 Set 5V 10kΩ pull up		
	Output	1 Set Photo Relay Output 300V DC/AC		
Event Notification		HTTP / FTP / SMTP		
Micro SD		microSDHC 32GB support		
Supported Web Browser		Internet Explorer (6.0+) / Chrome / Firefox / Safari		
User Account		20		
Password Levels		User and Administrator		
Mechanical				
Built-in IR Illuminator*	Working Distance	up to 30 m		
	Wavelength	850 nm		
	Number of LEDs	4		
LED Indicator		Power / Link / ACT		
Connectors	Type	Indoor	Outdoor	
	Alarm	4 of 8 Pin Terminal Block (Female)	4 Pin Terminal Block (Male)	
	Power	3 Pin Terminal Block (Female)	3 Pin Terminal Block (Male)	
	Ethernet	RJ-45	RJ-45	
	Analog Video	1.0 Vp-p / 75 Ω / BNC cable* (Installation purpose)	1.0 Vp-p / 75 Ω / BNC	
	Audio	4 of 8 Pin Terminal Block (Female)	Stereo phone jack, Ø 3.5 mm	
General				
Operating Temperature		-10°C ~ 50°C (14° ~ 122°F)		
Humidity		10% ~ 90%, No Condensation		
Weatherproof Standard*		IP66		
Dimension		Ø 117 x 84 mm (Ø 4.6 x 3.36 in.)		
Weight		220g		
Power Source		DC 12V / AC 24V / PoE		
Power Consumption		TBD		
Regulatory		CE / FCC		

* mark for optional items

Product specification and availability are subject to change without notice.